

AXGON

G1-100K



電子鎖 使用手冊 User Manual

Axgon Taiwan

【手冊圖片僅供參考，產品以實物為主】

目錄

1. 產品圖及產品清單 01

產品清單
產品圖
產品安裝圖

2. 產品簡介 03

3. 用戶編號說明 04

4. 管理設置 05

如何進入管理設置模式
管理設置選單
添加普通用戶
添加管理員
刪除用戶
系統管理
連網設置
系統資訊

5. 使用方法 08

在常用模式下
應急開啟方法
門鎖定
電池電量檢測
防貓眼撥鈕

6. 應用程式 10

下載APP
配網步驟

7. 安裝步驟 11

1. 產品圖及產品清單

1.1 產品清單

請拆開包裝後按清單仔細核對如發現有缺漏請及時向我們索取

| 序號 | 名稱 | 每套鎖具數量 |
|----|-----------|--------|
| 1 | 外面板(含矽膠墊) | 1 |
| 2 | 內面板(含矽膠墊) | 1 |
| 3 | 鑰匙 | 2 |
| 4 | 感應卡 | 2 |
| 5 | 產品保修卡 | 1 |
| 6 | 安裝配件包 | 1 |
| 7 | 使用手冊 | 1 |
| 8 | 鋰電池 | 2 |

1.2 產品圖

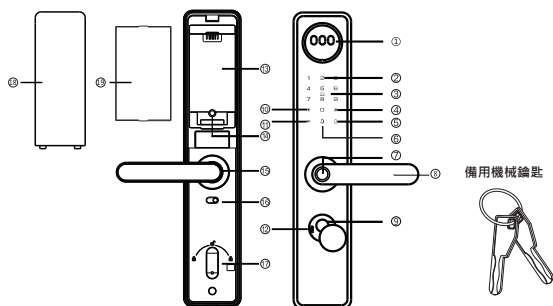

- | | | |
|---------|-----------|----------|
| ① 人臉識別區 | ② 數字鍵盤區 | ③ 卡片識別區 |
| ④ 確認鍵 | ⑤ 低電量提示燈 | ⑥ 門鈴 |
| ⑦ 指紋識別區 | ⑧ 外把手 | ⑨ 機械鑰匙孔 |
| ⑩ 返回鍵 | ⑪ 靜音按鍵 | ⑫ 緊急電源接口 |
| ⑬ 電池倉 | ⑭ 恢復原廠設定鍵 | ⑮ 內把手 |
| ⑯ 防貓眼開關 | ⑰ 反鎖旋鈕 | ⑱ 電池蓋 |
| ⑲ 鋰電池 | | |

注意 安裝說明使用圖片僅供參考，產品以實物為準

1.產品圖及產品清單

1.3產品安裝圖

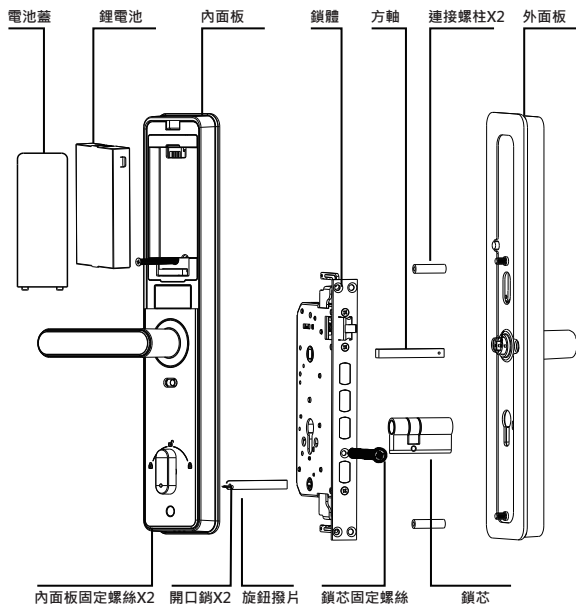

1.電池蓋

2.內面板

3.鎖體

4.方軸

5.連接螺柱X2

6.外面板

7.內面板固定螺絲X2

8.開口銷X2

9.旋鈕撥片

10.鎖芯固定螺絲

11.鎖芯

12.鋰電池(2個)

2.產品簡介

| | |
|-------|--|
| 指紋 | 採用半導體指紋傳感器，容量100枚 |
| 密碼 | 容量：50組，長度6-12位，具有虛位密碼功能(連續輸入最長20位數字)，只要有正確的密碼即可通過驗證，一次輸入超過20位數字則不識別。 |
| 導覽 | 全程語音提示導覽。 |
| 感應卡 | 容量:50張；附送兩張感應卡。 |
| 人臉 | 容量:50組 |
| 鑰匙 | 機械鑰匙2把。 |
| 電源 | 鋰電池供電，有外接電源接口 |
| 管理員 | 密碼、手指或感應卡可自由選擇，最少1個管理員，最多5個管理員(可刪除任何一位管理員，但至少需保留一個密碼管理員)。 |
| 其他功能 | 防撬警報、試錯警報、低電量警報。 |
| 出廠狀態 | 出廠狀態下任何人臉、指紋、感應卡、密碼都可以開鎖，如果有用戶註冊，出廠密碼將自動失效。 |
| 初始化設置 | 按住門後的出廠設置按鍵5秒鐘，根據提示“即將恢復出廠設置，請按#號鍵，返回請按*號鍵”，按#號鍵確認，語音提示“出廠設置恢復成功”。 |

3.用戶編號說明

| | |
|------|--|
| 用戶角色 | 管理員：人臉、指紋、密碼、感應卡。 普通用戶：人臉、指紋、密碼、感應卡。 |
| 用戶角色 | 一個編號只能註冊一種類型的用戶。 例如：註冊了8號指紋，就不能夠註冊8號密碼了。 編號自動遞增分配。 |
| 編號範圍 | 001-250 |

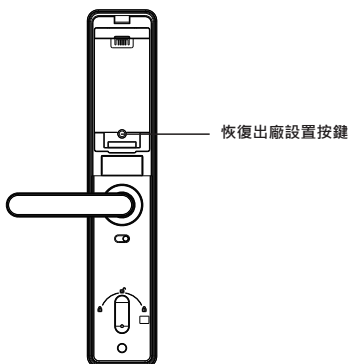

▲ 注意 恢復出廠狀態後，將清空所有用戶註冊信息。

4. 管理設置

4.1 如何進入管理設置模式

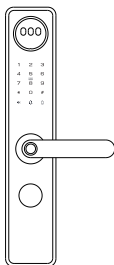

4.1.1 輕觸按鍵板喚醒門鎖後，依次按下 “*” “#” 鍵或者短按一次門後設置鍵進入管理設置。

4.1.2 初始化狀態下，將自動進入管理員密碼（編號固定為001）註冊選單，將提示：“註冊管理員，請添加指紋、密碼、感應卡”，如果已經註冊過管理員，將提示：“請授權”。

▲ 注意 如果識別管理員失敗，語音撥放“驗證管理員失敗，請授權”。如果識別成功，直接進入設置主選單，按*號鍵可退出，按相應的數字則進入子選單。

4.2 管理設置單

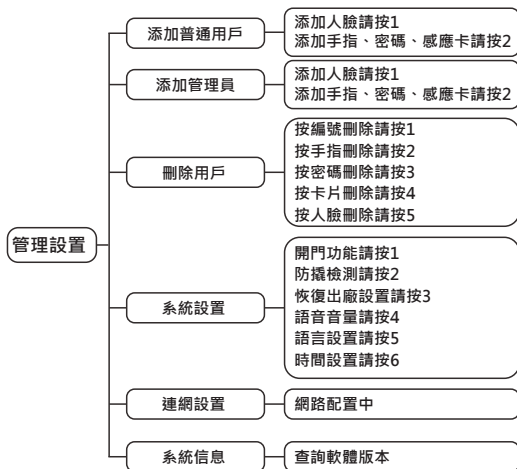

▲ 注意 上述操作過程中，全語音提示，您可以按照語音提示操作。

4. 管理設置

4.3 添加普通用戶

進入添加普通用戶，語音撥放“添加人臉請按1，添加指紋、密碼、感應卡請按2”根據用戶錄入人臉、按手指、輸入密碼還是刷卡來決定添加的是人臉、指紋、密碼還是感應卡。

4.3.1 添加人臉

用戶添加人臉，語音撥放“請注視攝像頭，返回請按*號鍵”，人臉錄入成功後語音提示“新用戶註冊成功，編號XXX”，失敗則提示“添加失敗”返回上一級選單。

4.3.2 添加指紋

用戶添加第一次手指，語音撥放“請抬起手指繼續錄入其他區域”，用戶按下第二次手指，重複此步驟，連續按下5次手指，如果手指添加成功，語音撥放“新用戶註冊成功，編號XXX”，失敗則提示“添加失敗”返回上一級選單。

▲ 注意 隨季節環境變化，手指特徵點會存在清晰度的偏差，導致識別率變化，當用戶使用辨識率降低時，可重新錄入對應的手指。

4.3.3 添加密碼

用戶輸入密碼，按#鍵，語音撥放“請再次輸入同一密碼，按#號鍵確認”，用戶再輸入密碼，如果兩次密碼一樣，語音撥放“新用戶註冊成功，編號XXX”，失敗則提示“密碼不一致，請重新輸入”返回上一級選單。

4.3.4 添加感應卡

用戶添加卡片，成功語音撥放“新用戶註冊成功，編號XXX”，失敗則“卡片無法識別，添加失敗”。

▲ 注意 如果人臉/指紋/感應卡已滿，語音撥放“人臉/指紋/密碼/感應卡已滿”。
如果密碼/感應卡已註冊，語音撥放“密碼/感應卡已存在”。
如果用戶已註冊滿，語音撥放“用戶已滿”。

4.4 添加管理員

進入添加普通用戶，語音撥放“添加人臉請按1，添加指紋、密碼、感應卡請按2”。進入添加普通用戶，語音撥放“添加人臉請按1，添加指紋、密碼、感應卡請按2”。還是感應卡，其他操作流程同4.3添加普通用戶。

4.5 刪除用戶

進入刪除用戶，語音撥放“按編號刪除請按1，按手指刪除請按2，按密碼刪除請按3，按卡片刪除請按4按人臉刪除請按5”。

按1，按編號刪除，語音撥放“請輸入編號”，輸入用戶編號後，按#號鍵確認。如果刪除成功，語音撥放“編號XXX刪除成功”。可繼續輸入編號，進行刪除，返回上一級選單按*鍵。

按2，按手指刪除，語音撥放“請驗證用戶”，錄入需要刪除的手指，如果刪除成功，語音撥放“刪除成功”。刪除成功後自動返回上一級選單。

4. 管理設置

按3，按密碼刪除，語音撥放“請驗證用戶”，錄入需要刪除的密碼，如果刪除成功，語音撥放“刪除成功”。刪除成功後自動返回上一級選單。

按4，按卡片刪除，語音撥放“請驗證用戶”，錄入需要刪除的卡片，如果刪除成功，語音撥放“刪除成功”。刪除成功後自動返回上一級選單。

按5，按人臉刪除，語音撥放“請驗證用戶”，錄入需要刪除的人臉，如果刪除成功，語音撥放“刪除成功”。刪除成功後自動返回上一級選單。

▲ 注意 如果人臉、指紋、密碼、感應卡並未註冊，語音撥放“用戶不存在”，跳轉到上一步。

4.6 系統管理

進入系統設置，語音撥放“開門功能請按1，防撬檢測請按2，恢復出廠設置請按3，語言音量請按4，語言設置請按5，設置時間請按6，返回請按*號鍵”。

| | |
|--------|-------------------------------------|
| 開門功能 | 常開設置請按1，開鎖設置請按2，返回請按*號鍵。 |
| 防撬檢測 | 打開防撬檢測請按1，關閉防撬檢測請按2，返回請按*號鍵 |
| 恢復出廠設置 | 即將恢復出廠設置，請按#號鍵，返回請按*號鍵。 |
| 語言音量 | 高音量請按1，中音量請按2，低音量請按3，靜音請按4，返回請按*號鍵。 |
| 語言設置 | 選擇中文請按1，選擇英文請按2，返回請按*號鍵。 |
| 設置時間 | 根據語音提示分別輸入年、月、日、時、分、秒。 |

4.7 連網設置

進入連網設置，語音撥放“網路配置中”。

4.8 系統信息

查詢軟體版本：語音播報當前版本信息。

5. 使用方法

5.1 在常用模式下

5.1.1 人臉開鎖



錄入已添加的人臉，人臉驗證成功語音提示“已開鎖”。

5.1.2 密碼開鎖



a、輸入已添加的密碼，按#號鍵確認，密碼驗證成功語音提示“叮鈴鈴，請按把手開門”。

b、向下壓把手開鎖。

△ 注意

注意用戶密碼前後可任意添加虛位密碼，包含虛位密碼在內的長度不要超過20位，徹底消除開門密碼洩漏的風險。

5.1.3 指紋開鎖

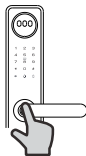

a、將已添加的手指以正確的方式放在指紋採集器上，指紋驗證成功語音提示“叮鈴鈴請按把手開門”。

b、向下壓把手開鎖。

5.1.4 刷卡開鎖

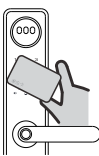

a、將已添加的感應卡靠近或者貼在鍵盤區，感應卡驗證成功語音提示“叮鈴鈴，請按把手開門”。

b、向下壓把手開鎖。

5.2 應急開啟方法

5.2.1 機械鑰匙開啟

若出現忘記密碼，電池電量耗盡或系統無法運作等緊急情況，可使用備用機械鑰匙開鎖。



a、旋轉前板鑰匙孔蓋，即可看到鑰匙孔。

b、將鑰匙插入備用機械鑰匙口。

c、轉動鑰匙後，下壓把手，即可開鎖。

5. 使用方法

5.2.2 USB緊急供電

當電池耗盡且沒有帶鑰匙的情況，可外接行動電源或5V1A電源緊急供電，按正常的操作步驟開門即可。應急電源開門後請及時更換鎖內電池。

5.3 門鎖定

5.3.1 外部鎖定

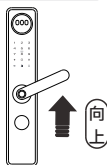

室外把手向上提鎖定。

5.3.2 內部鎖定

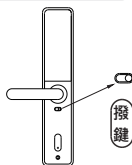

後板防貓眼撥鈕撥向右邊，防貓眼功能開啟，內部鎖定。

5.3.3 內部反鎖

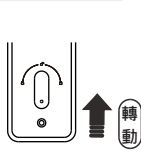

旋轉按鈕，進行反鎖，此時從室外無法正常開啟，需室內解鎖。

5.4 常開功能

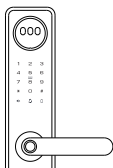

5.4.1 常開功能

當舉行會議或其他集體活動時，可將門鎖設置成常開狀態，設置成功後無需其他操作，扳下把手就可以開門。

5.4.2 常開功能設置方法

進入系統設置，按1號鍵進入常開設置模式，根據語音提示選擇打開常開。

5.5 試開凍結功能

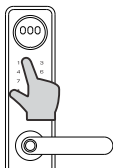

當人臉、指紋、密碼、感應卡在5分鐘內錯誤次數連續 ≥ 3 時發出聲光警報；5分鐘內錯誤次數連續 ≥ 5 次時，系統凍結120秒，120秒內不可再識別別人臉、指紋、密碼、感應卡。

5. 使用方法

5.6 電池電量檢測



當電池電壓低於6.5V-6.8V之間時，可正常識別，每次用戶驗證成功會語音提示“電池電量低，請更換電池”。電壓低於6.5V時，語音提示“電池電量嚴重不足”。

5.7 防貓眼撥鈕

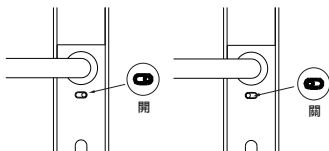

撥鈕撥向右邊，防貓眼功能開啟
(此時在門內下壓把手不能開門)
撥鈕撥向左邊，防貓眼功能關閉
(此時在門內下壓把手開門)

6. 應用程式

6.1 下載APP

安卓用戶在PLAY商店搜尋“Axgon”APP下載並註冊，IOS在App Store搜尋“Axgon”APP下載並註冊。

6.2 配網步驟

1、鎖端操作步驟：

進入設置選單，按“5”進入連網設置，提示“網路配置中”。

2、APP上操作步驟：

1. 點擊介面右上角“+”進入“安防監控”選項並選擇“WiFi門鎖”。
2. 進入重置設備介面，無須重置，直接點擊“確認鍵盤燈快閃”。
3. 輸入家中2.4GWiFi密碼。
4. APP輸入WiFi密碼點擊後確認，等待連接。
5. 設備添加成功，如添加設備失敗，無法搜索到設備，請重置後重新添加。
6. 添加成功介面。

7. 安裝步驟

零件明細：

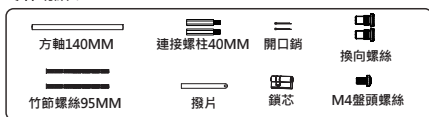

一、安裝鎖體

- 1、將鎖體放入已開好門孔的門內，並固定好鎖體。
- 2、將鎖芯插入鎖體內（注意正反面），並通過螺絲固定。

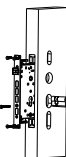

二、前把手換向

如要換向安裝，要將外面板背面的換向螺絲鬆開（如圖），再將把手旋轉180度後擰緊換向螺絲。

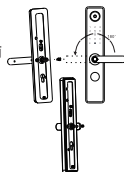

三、後把手換向

如要換向安裝，要將內面板背面的換向螺絲鬆開（如圖），再將把手旋轉180度後擰緊換向螺絲，後將M4盤頭螺絲固定與換向螺絲對應的「L、R」標示字樣的孔位。

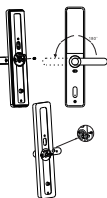

四、切割定位柱等配件

在外面的無頭螺柱上擰緊兩顆連接螺柱，將方軸裁減為合適長度後，放入到前面板的方孔用開口銷固定。

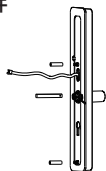

五、安裝固定外面板

- 1、將外面板連接線穿過最上端的過線孔。
- 2、將外面板上的方軸穿過鎖體的方孔，內面板緊貼門外側。

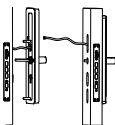

六、安裝內面板

- 1、將內面板連接線端子和外面板端子連接起來。
- 2、將旋鈕撥片進行裁剪其長度短於門厚度5-10mm，插入內面板反鎖旋鈕槽口內，並用開口銷固定。



七、固定內面板

將內面板緊貼門內側，並用兩顆面板固定螺絲固定。



八、測試智能鎖

- 1、裝上電池和後板電池蓋。
- 2、操作內外把手、保險旋鈕和機械鑰匙檢查各零件是否工作正常。

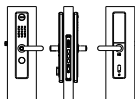

EXPO

取得審驗證明之低功率射頻器材，非經核准，公司、商號或使用者均不得擅自變更頻率、加大功率或變更原設計之特性及功能。低功率射頻器材之使用不得影響飛航安全及干擾合法通信；經發現有干擾現象時，應立即停用，並改善至無干擾時方得繼續使用。前述合法通信，指依電信管理法規定作業之無線電通信。低功率射頻器材須忍受合法通信或工業、科學及醫療用電波輻射性電機設備之干擾。

axgon

G1-100K



Smart Lock User Manual

Axgon Taiwan

The pictures in this manual are for reference only
and the products are mainly in kind.

Conent

| | |
|---|-----------|
| 1. Product Picture and List | 01 |
| Product List | |
| product picture | |
| Product Exploded View | |
| 2. Product introduction | 03 |
| 3. User ID Description | 04 |
| 4. Management settings | 05 |
| How To Enter The Management Settings Mode | |
| Managment Settings Menu | |
| Add User | |
| Add administrator | |
| Delete user | |
| Managment Setting | |
| Networking Settings | |
| System Information | |
| 5. How To Use | 08 |
| In Common Mode | |
| Emergency Unlock | |
| Door Lock | |
| Battery Level Detection | |
| Anti-peek Hole Unlock Button | |
| 6. App Operation | 11 |
| Download APP | |
| Network Configuration | |
| 7. Installation Steps | 12 |

1.Product Picture And List

1.1 Product List

After unpacking, please check carefully according to the list, if you find any omissions, please ask us for it in time.

| Ref | Name | Quantity |
|-----|-------------------------------------|----------|
| 1 | Outer body (Rubber pad included) | 1 |
| 2 | Inner body (Rubber pad included) | 1 |
| 3 | Key | 2 |
| 4 | Card | 2 |
| 5 | Warranty Card | 1 |
| 6 | Accessory kit | 1 |
| 7 | Manual | 1 |
| 8 | Lithium Batttery | 2 |

1.2 Product Picture

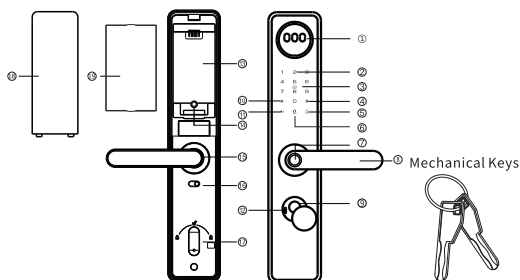

- | | | |
|-----------------------|----------------------|-----------------------------|
| ① Face Recognition | ② Touch Keypad | ③ Card Reader |
| ④ Confirm | ⑤ Show Battery Level | ⑥ Door bell |
| ⑦ Fingerprint Sensor | ⑧ Exterior handle | ⑨ Key Hole |
| ⑩ Return | ⑪ Mute | ⑫ Emergency Power Interface |
| ⑬ Battery Compartment | ⑭ Setting Button | ⑮ Interior Handle |
| ⑯ Anti-peek Hole | ⑰ Safety Knob | ⑱ Battery Cover |
| ⑲ Lithium Battery | | |

Note The pictures used in the installation manual are for reference only and the product is subject to the actual product.

1.Product Picture And List

1.3 Product Exploded View

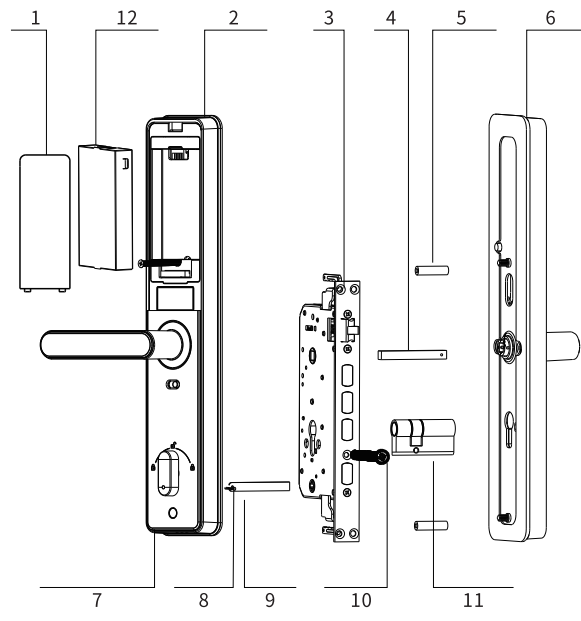

- | | | |
|------------------------------|-----------------------|-----------------------|
| 1、Battery Cover | 2、Inner Body | 3、Mortise |
| 4、Square Shaft | 5、Connection Stud X2 | 6、Outer Body |
| 7、Inner body Fixing screw X2 | 8、Cotter Pin X2 | 9、Knob -Pin |
| 10、Cylinder Fixing Screw | 11、Emergency Cylinder | 12、Lithium battery X2 |

2.Product introduction

| | |
|-------------------------|---|
| Fingerprint | Using semiconductor fingerprint sensor with a capacity of 100 fingerprints; |
| Password | The capacity is 50 passwords,the length is 6~12 digits.And it has the function of dummy password (enter the longest number of 20 digits continuously). As long as there is the correct password, the verification can be passed, and the input of more than 20 digits at a time will not recognize; |
| Navigation | Full voice prompt navigation; |
| Proximity card | 50 cards in capacity, 2 proximity cards included; |
| Face | Capacity: 50 |
| Key | 2 pcs mechanical keys |
| Power supply | Lithium battery power supply with external power interface |
| Administrator | The 1st administrator must be password.Password, fingerprint or proximity card can be freely selected, minimum 1 administrator,maximum 5 administrators (any administrator can be deleted, but at least one administrator is retained). |
| Other functions | Anti-pry alarm, trial and error alarm, low battery alarm; |
| Factory state | In the factory state, the user database is empty, any one can unlock the door without authentication by face/card/ fingerprint/password(123456)Factory passwords are automatically invalidated after user registration |
| Initialization settings | Press and hold the set button on the interior panel and according to the prompt “Restore the factory state, press # to confirm, press * to exit.” After pressing #wait a few seonds to heard “initialization successful”. |

3.User ID Description

| | |
|--------------------------|---|
| User Attributes | Administrator:Face,password,proximity card Fingerprint;User:Face,password,proximity card Fingerprint. |
| User Number Relationship | A number can only register one type of user.For example, if you register fingerprint No.8, you can not register password No. 8. The number is automatically assigned incrementally. |
| Number Range | 001-250 |

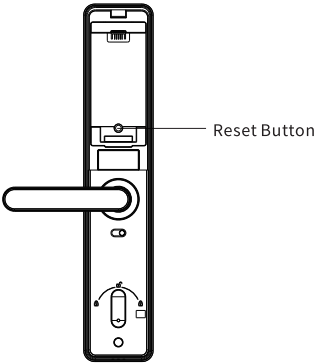

Note After restoring the factory state, all user registration information will be cleared.

4.Management settings

4.1 How To Enter The Management Settings Mode

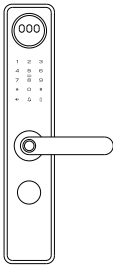

4.1.1 After short touching the keypad to activate the door lock, press " * # " in turn or short press the set button once to enter the management setting.

4.1.2 In the factory state, it will automatically enter the administrator password (the number is fixed to 001) registration menu, it will prompt "add administrator, please add finger, password, proximity card" If the administrator has already been registered, it will prompt "please authorize"



Note

If the identification of the administrator fails, the voice plays "input error" If the recognition is successful, it will enter the main menu directly, press to exit, and press the corresponding number to enter the sub-menu.

4.2 Management settings Menu

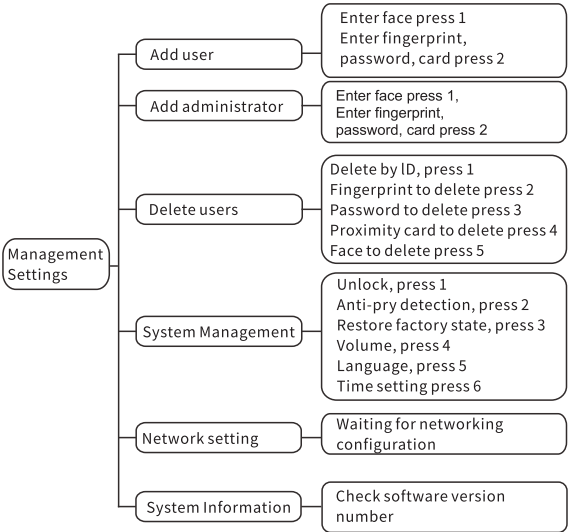

Note

Above operations are voice prompted.

4.Management settings

4.3 Add User >>

Enter to add user, voice play “Add face press1, add fingerprint, password, card press 2, press * to exit”.

4.3.1 Add face

If the user enters a face for the first time,the voice play “number XX successful ,continue input face press # confirm,press * to exit .”

4.3.2 Add fingerprint

If the user press the fingerprint for the first time, the voice play “please touch the other area”, and the user press the fingerprint for the second time. Repeat press the fingerprint 5 times. If the fingerprint is added successfully, the voice will play “Register success , index number XXX”.Otherwise, the voice play “failed”.

Note With seasonal environmental changes, there will be deviations in the clarity of fingerprint feature points, resulting in changes in recognition rate. When the recognition rate decreases, customer shall re-enter the corresponding fingerprint.

4.3.3 Add password

If the user enters the password, press # to confirm, the voice plays “Please enter new password again”, the user enters the password again, if the password is same, the voice plays “Register success ,index number XXX”. Otherwise, voice plays “Incosistant password input”, return to previous menu .

4.3.4 Add proximity card

If the user add proximity card, the voice plays “Register Success, index numberXXX”, otherwise the voice plays “Card is not recognized, adding failed”.

Note If the face, fingerprint, password and proximity card are full, the voice plays “face/ fingerprint/ password /card is full.” If the face, fingerprint, password and proximity card are already registered, the voice plays “face/fingerprint/password /proximity card already exist”. If the user is fully registered, the voice plays “User is full”.

4.4 Add administrator >>

Enter to add administrator, voice play “Add face press 1, add fingerprint password, proximity card press2.” Other operation process is the same as 4.3. Adding user .

4.5 Delete user >>

Enter to delete user, voice play “delete by ID press 1, delete by fingerprint press 2, delete by password press 3, delete by proximity card press4 delete by face press 5, press * to exit.”

4.Management settings

1. Press 1, delete by ID voice play “Please enter the number”, after number enter, press # to confirm. If the deletion is successful, the voice will play “Delete administrator/user XXX successfully”. You can continue to enter the number to delete, or press * return to the previous menu.

2.Press 2, fingerprint to delete , voice play “Please verify user”, after Input the voice will play “Delete administrator /user XXX successfully”,You can continue to enter the fingerprint to delete or press * return to the previous menu

3.Press 3, password to delete , voice play “Please verify user”, after Input the voice will play “Delete administrator/ user XXX successfully”.You can continue to enter the password to delete or press * return to the previous menu

4.Press 4, proximity card to delete , voice play “Please verify user”, after input the voice will play “Delete administrator/ user XXX successfully”, You can continue to enter the proximity card to delete or press * return to the previous menu.

5.Press 5, face to delete , voice play “Please verify user”, after input the face will play “Delete administrator /user XXX successfully”, You can continue to enter the face to delete or press * return to the previous menu.

 **Note** If the fingerprint, password and proximity card are not registered, the voice plays “No user, no card” to skip to the previous step.

4.6 Management Setting >>

Enter the system management, the voice plays “Door opening function press 1, anti-pry detection press 2, restore factory state press 3, volume press 4, language press 5, timesetting press 6.press * to exit”

Door opening function: Voice play “Passageway press 1, auto lock press 2,press* to exit”

Anti-pry detection: Voice plays “Enable anti-pry detection press 1, Disable anti-pry detection press 2, press * to exit”

Restore factory state: Voice plays “Restore factory state, press # to confirm, press * to exit”

Volume: Voice play , “Hight volume press1, mid-range volume press2, bass volume press 3, mute press 4 and press * to exit”

Language: Chinese press 1, English press 2 and press * to exit”

Time setting: Enter the year, month, day, hour, minute, and second according to the voice prompts

4.7 Networking Settings

To enter the Network Setting menu , the voice will play: “network configuring”

4.8 System Information

Check software version number : the voice will play Current version information

5.How To Use

5.1 In common Mode

5.1.1 Face unlocking

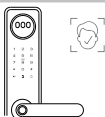

Voice prompt “please open the door” after face recognition succeeded.

5.1.2 Password unlocking



- A. Enter the registered password, press # to confirm, the password verification success voice prompt “please open the door”.
- B. Press down the handle to unlock

Note Dummy password function is supported, and the length of the password including the dummy password should not exceed 20 bits to completely eliminate the risk of peeping password

5.1.3 Fingerprint unlocking

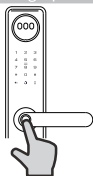

- A. Put the registered fingerprint on the fingerprint reader in the correct way, the fingerprint verification is successful, and the voice prompts “please open the door”.
- B. Press down the handle to unlock

5.1.4 Card unlocking



- A. Place the added proximity card close to or paste it on the keypad area, and the proximity card will be verified successfully and the voice prompt “Please open the door”.
- B. Press down the handle to unlock

5.How To Use

5.2 Emergency Unlock

5.2.1 Mechanical Key Unlock

In case of emergency, such as forgetting the password, running out of battery power or system inoperability, a spare mechanical key can be used.



- Rotate the outer body keyhole cover to see the key hole.
- Insert the key into key hole.
- Turn the key and press down handle to unlock.

5.2.2 USB Emergency Power Supply

When the battery is exhausted and there is no key, you can connect an external power bank or 5V1A power supply for emergency, and open the door according to the normal operation steps. Please replace the battery in time after the emergency unlock.

5.3 Door Lock

5.3.1 Outside Lock

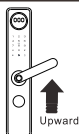

Up-Lifting the handle to lock the door from outside

5.3.2 Inside Lock

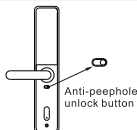

Turn the button to enable and disable the function and prevent kids or pet unlock the door by accident.

5.3.3 Door Inside Safety Knob



Rotate the safety knob to lock position.

Rotate the safety knob to lock position. At this time, it cannot be opened normally from the outside and needs to be unlocked from door inside.

5. How To Use

5.4 Passageway Function

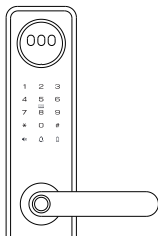

5.4.1 Passageway Function

When a group meeting or other group activity is held, the door lock can be set to the passageway state, and the door can be opened by pressing down the handle after successful setting without any other operation. Any effective verification, including password, card, fingerprint will disable passageway function directly.

5.4.2 Passageway Setting Method

Enter the system settings, press 1 to enter the passageway setting mode, and choose to enable passageway mode according to the voice prompt.

5.5 Trail Freeze Function

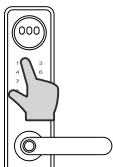

When the number of errors of face, passwords, fingerprints and cards within 5 minutes is ≥ 3 consecutively, an audible and visual alarm will be issued; when the number of errors within 5 minutes is ≥ 5 , the system freezes for 120 seconds, and fingerprints, passwords, and cards can no longer be identified within 120 seconds.

5.6 Battery Level Detection

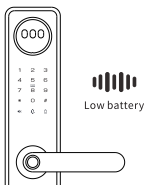

When the battery voltage is lower than 6.5V-6.8V, it can be unlocked normally but with a voice prompt "Low power please replace the battery".

5.How To Use

5.7 Anti-peek Hole Unlock Button

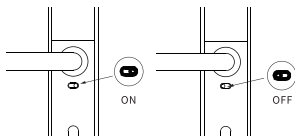

Push the button to the right, anti-peekhole function enabled. (At this time you cannot open the door by pushing down the handle inside the door). Push the button to the left, anti-peekhole function disabled. (At this time, you can press the handle from door inside to unlock).

6.App Operation

6.1 Download APP

Please enter the APP store to download and install “Axgon”.

6.2 Network Configuration

Operation on the lock

Enter system menu, press 5 enter network configuration.

Operation in the APP

Press “Add device”, select “Camera&Lock”, and chose “WiFi Lock”.

Input the WiFi name and password and waiting for connection.

The lock will show in the APP once connected.

7.Installation Steps

Parts List

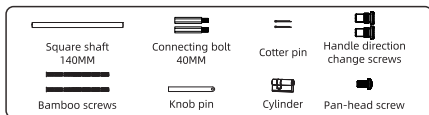

1.Install Mortise

- Place the mortise into the hole and fix it properly.
- Insert the cylinder into the mortise (note the front and back) and fix it with screws.

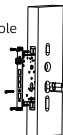

2.Exterior Handle Direction Change

To change the handle direction, please loose the screw from outer body(as figure)and turn the handle 180° and tighten the screw.

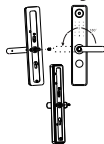

3.Interior Handle Direction Change

Please loose the screw from inner body(as figure), then turn the handle 180°and tighten the screw. Then fix M4 pan-head screw into the hole with "L,R" mark correspondingly.

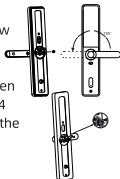

4.Cutting Positioning Column And Other Accessories

Tighten the two connecting bolts on the outer headless studs, cut the square shaft to a suitable length, and put it into the square hole of the outer body to fix it with a split pin.

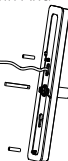

5.Install And Fix Outer Body

- Pass the outer body cable through the uppermost cable hole.
- Pass the square shaft on the outer body through the square hole of the mortise, and the inner panel is close to the outside of the door.

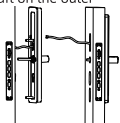

6.Install Inner Body

- Connect the inner body connecting line segment with the outer body segment.
- Cut the knob pin to a length shorter than the thickness of the door by 5~10mm, insert it into the notch of the safety knob on the inner body, and fix it with a split pin.



7.Fix Inner Body

Place the inner body close to the inside of the door and fix it with two bamboo screws.



8.Test Smart Lock

- Install the battery and the battery cover on the inner body.
- Operate the internal and external handles, safety knobs and mechanical keys to check whether the connecting parts are working well.

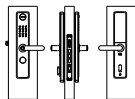

חספא